



PS-6V390

6 Volt 390 AH @ 20-hr. rate

Rechargeable Sealed Lead Acid Battery
Designed for Cyclic, Standby, and Solar Applications

We've Got The Power.™



Terminals - AM (Pos: 19.5mm, Neg:17.9mm)

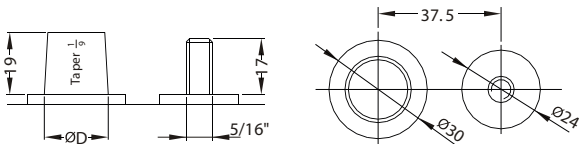

Physical Dimensions: in (mm)

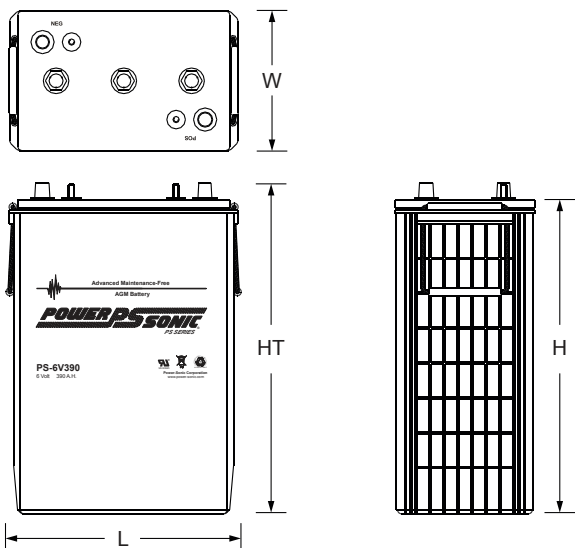

L: 11.61 (295) W: 7.09 (180) H: 15.94 (405) HT: 16.85 (428)

Tolerances are +/- 0.04 in. (+/- 1mm) and +/- 0.08 in. (+/- 2mm) for height dimensions. All data subject to change without notice.

Features

- **Maintenance-Free, Non-Spillable** - Proven VRLA technology guarantees safe operation without maintenance and 'nonrestricted article' status for air, land or water transportation.
- **Long Service Life** - High capacity design, excellent deep cycle property.
- **Low Internal Resistance** - High strength conductive terminals for high current discharging.
- **Designed-in Reliability** - Cutting-edge manufacturing and process control combined with meticulous quality assurance procedures guarantee consistent and dependable performance.

Performance Specifications

Nominal Voltage	6 volts (3 cells)
Nominal Capacity	
20-hr. (19.5A to 5.40 volts)	390 AH
5-hr. (66.2A to 5.25 volts)	331 AH
Approximate Weight	122.7 lbs. (55.7 kg)
Reserve Capacity (25 Amps)	915 min.
Reserve Capacity (75 Amps)	255 min.
Charge Methods (Constant voltage charging at 20 °C (68 °F))	
Standby (Max. charge current: 0.25C ₂₀ A)	6.80-6.90V
Cyclic (Max. charge current: 0.25C ₂₀ A)	7.20-7.35V
Operating Temperature Range	
Charge ..	-14 °F (-10 °C) to 122 °F (50 °C)
Discharge	-4 °F (-20 °C) to 140 °F (60 °C)
Case	ABS Plastic

Cycle Life in Relation to Depth of Discharge

